

23 Messingham Grange Lodges Butterwick Road, Scunthorpe, DN17 3PP

£94,500

Brilliant opportunity to own a holiday lodge on the idyllic Messingham Grange. Updated by the current owners this is perfect as a home from home or a smart investment with short term holiday let potential. This lodge consists of a really spacious lounge with patio doors on to the decking area, kitchen with separate utility area, dining room, two double bedrooms with an en suite to the master and a family bathroom. Messingham Grange homes are bought with a 12 month holiday licence with amenities available on site for residents and visitors. Available for viewings now please call to book your appointment.

Utility 7'2" x 5'5" (2.19 x 1.66)

Pantry

Kitchen 10'4" x 9'3" (3.17 x 2.82)



Dining room 10'5" x 9'10" (3.18 x 3.00)



Lounge 21'4" x 12'7" (6.52 x 3.85)



Inner hallway

Bathroom 6'11" x 5'10" (2.13 x 1.79)



Bedroom one 10'5" x 10'4" (3.18 x 3.17)



Dressing area

En suite 5'9" x 4'5" (1.76 x 1.37)

Bedroom two 10'5" x 11'2" (3.18 x 3.42)



Dressing area

Outside



Ground Floor
Approx. 87.5 sq. metres (942.1 sq. feet)

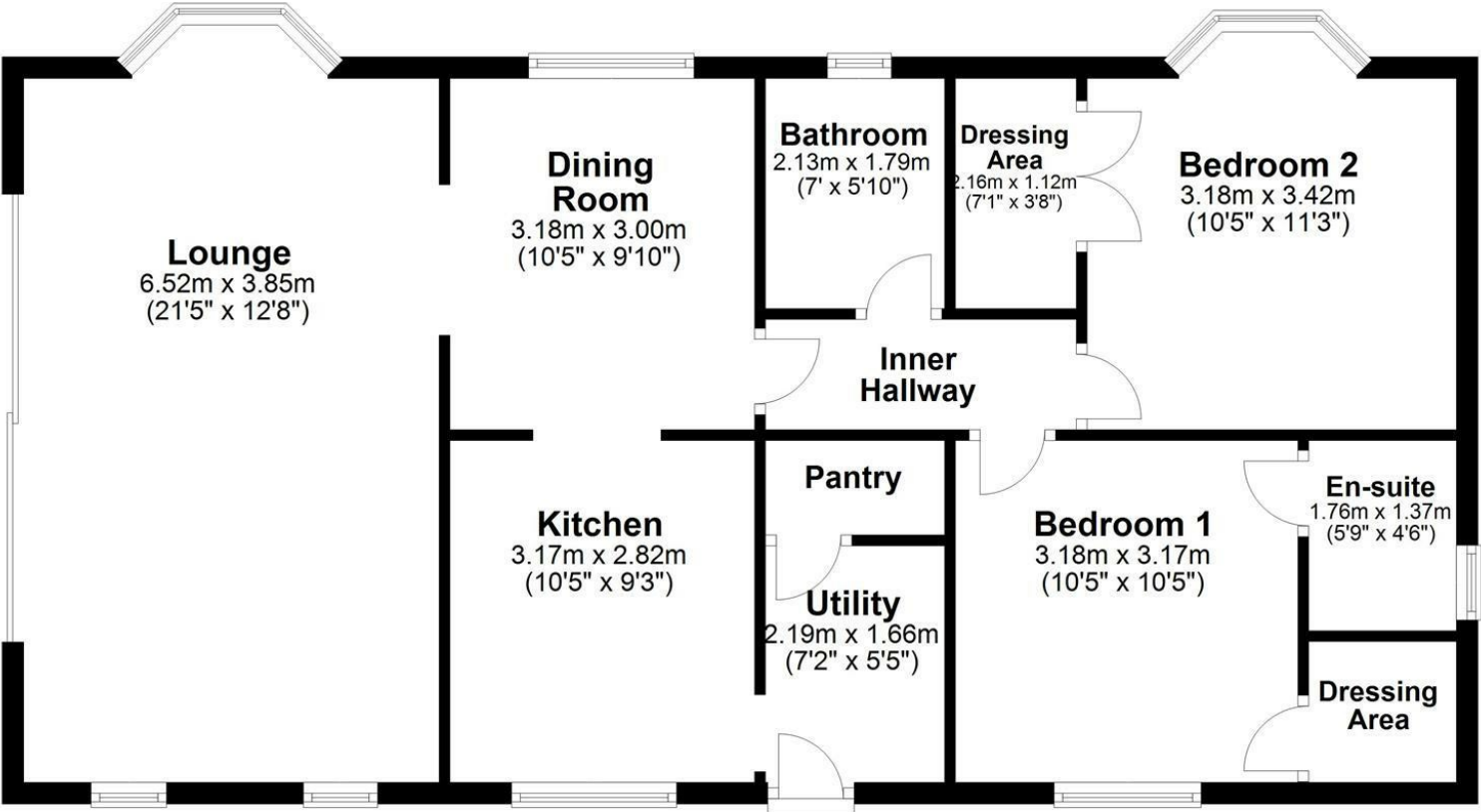

Total area: approx. 87.5 sq. metres (942.1 sq. feet)

Area Map

Energy Efficiency Graph



These particulars, whilst believed to be accurate are set out as a general outline only for guidance and do not constitute any part of an offer or contract. Intending purchasers should not rely on them as statements of representation of fact, but must satisfy themselves by inspection or otherwise as to their accuracy. No person in this firms employment has the authority to make or give any representation or warranty in respect of the property.